

TYPICAL SECTION
NOT TO SCALE

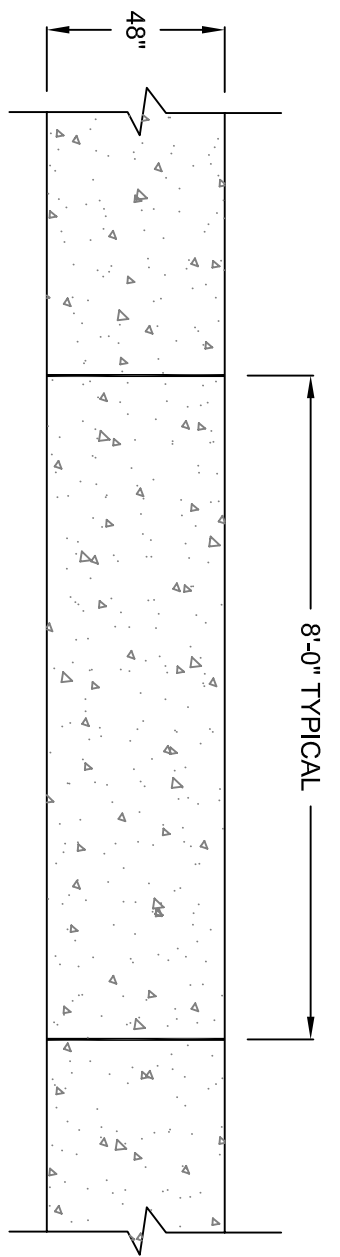

JOINT SPACING - PLAN VIEW
NOT TO SCALE

- NOTES:**
1. PERVIOUS CONCRETE MUST BE SUPPLIED AND INSTALLED BY NRMCA CERTIFIED TECHNICIANS.
 2. JOINTS TO BE CUT IN FRESH PAVEMENT WITH A PERVIOUS CONCRETE JOINT CUTTING TOOL ONLY.
 3. PERVIOUS CONCRETE MUST BE COVERED WITH 6 MIL PLASTIC, SECURELY FASTENED, FOR SEVEN (7) DAYS.



INSTALLATION



JOINT CUTTING



CURING

"The information contained herein is provided for use by PROFESSIONAL PERSONNEL who are competent to evaluate the significance and limitations of the information provided and who will accept total responsibility for the application of this information. The Northeast Cement Shippers Association makes no representations or warranties concerning the fitness of this information for any particular application or installation and DISCLAIMS any and all RESPONSIBILITY and LIABILITY for the accuracy of and the application of the information provided to the full extent of the law."

**TYPICAL SIDEWALK DETAILS
LESS THAN 1% SLOPE**



K. M. JUSTICE, P.E.
PO BOX 911
CONSHOHOCKEN, PA
(610) 828-5119

PERVIOUS CONCRETE SIDEWALK

SCALE:	NONE
DRAWN BY:	KMJ
DATE:	4/4/07

FOR: